

# KETTENKRAD

Compatible to Radio Control system



## Sd.Kfz. 2 1/16 Scale

AD-06026-16R/C

The Sd.Kfz 2, better known as the Kleines Kettenkraftrad HK 101 or Kettenkrad for short (Ketten = tracks, kraf = military abbreviation of the German word Kraftrad, the administrative German term for motorcycle) unusual vehicle that was a hybrid between a tracked vehicle and a motorcycle, and was the smallest tractor used by the German Army.

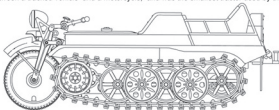

**Andrew Design 1/16 Professional Line Sd.Kfz.2 Kettenkrad -Compatible to Radio Control System, Metal Track, high Power 370 Motor, Rubber Tire, LED Light, Photo Etched Plate, Nylon Gear.**



[www.andrew-design.com](http://www.andrew-design.com)

READ BEFORE  
ASSEMBLY



- Study and understand these instructions thoroughly before beginning assembly. Make sure all parts are included by comparing them to those shown on pages 13 of these instructions.
- Remove parts from sprues as needed, and trim excess with a hobby knife. Be careful not to lose small parts.
- Apply decals to necessary parts prior to assembly.
- Remove photo-etch parts from sprue as needed using a hobby knife or photo etch cutter.

- Apply cement to photo etch parts as shown on instructions. Applying too much cement will restrict the operation of these movable parts. Apply cement carefully! Removed photo etch parts can have sharp edges. Take care when handling these to avoid injury.
- Additional tools recommended (not included) Sprue cutter, Long nose pliers, hobby knife, file, tweezers, pinvise, scissors, cement, sandpaper, grease, R/C system, 6V AAA(X5) battery, glue and paint.
- Keep all parts out of reach of children, as they pose a choking hazard. Discard all unnecessary bags and sprues when model is completed to avoid accidental injury.

## R/C System

(Not Included)

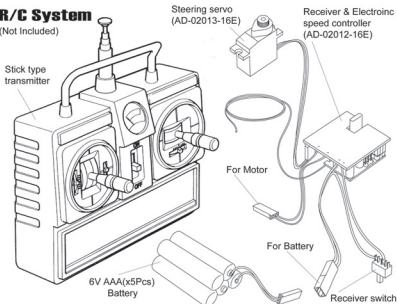

+ Screwdriver  
medium & large



Side cutters



Instant cement



File



Modeling knife



Synthetic rubber cement

1

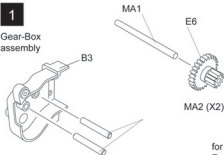
Gear-Box  
assemblyfor 280 Motor  
Remove Grey area

2

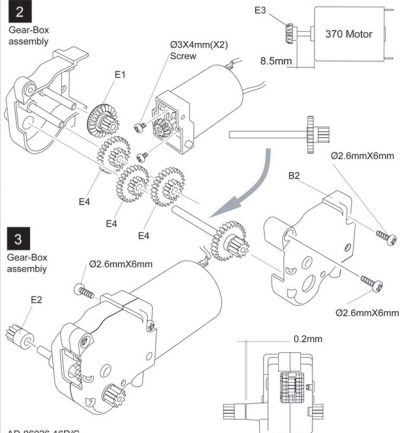
Gear-Box  
assembly

3

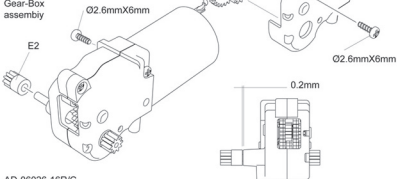
Gear-Box  
assembly

4

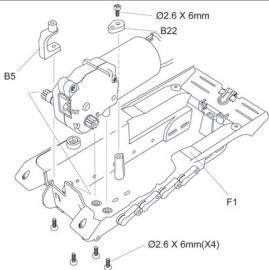
Chassis  
assembly

5

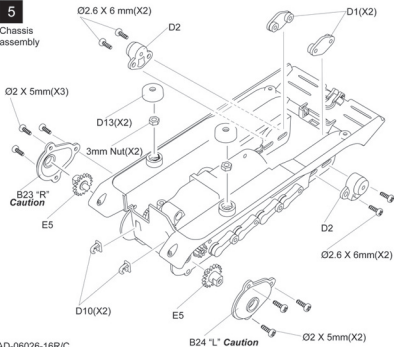
Chassis  
assembly



8

Chassis assembly

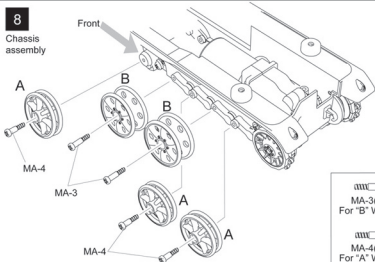

9

Chassis assembly

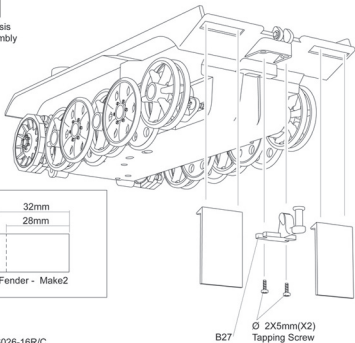

10

R/C  
assemblyFor Steering Servo  
(Note direction Black /  
Brown)

For Motor

Ø 2.6X6mm(X2)

Steering Servo  
(AD-02013-16E)  
Not Included

LED cable

Antenna

Receiver / Electronic speed  
controller (AD-02012-16E)  
Not Included

B29

For Battery

Receiver Switch

11

Body  
assembly

LED cable

B28

Soldering

Remove Grey area  
(For LED cable)

A4

LED (Red Color)

B26

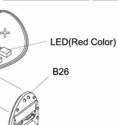
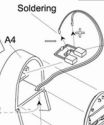
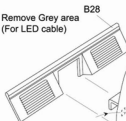

12

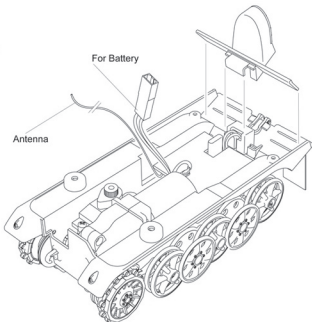
Body  
assembly

13

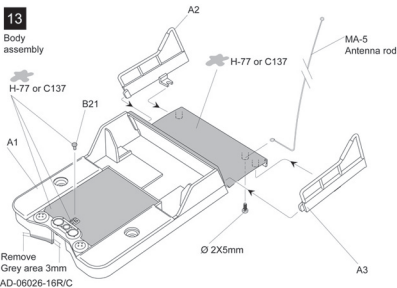
Body  
assembly

GEAR BOX

CHASSIS

R/C SYSTEM

BODY

TRACKS

DECO



14

## Body assembly

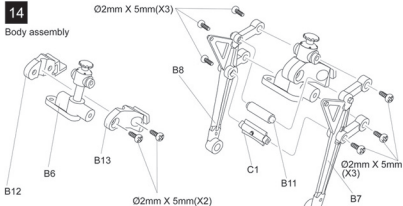

15

## Body assembly

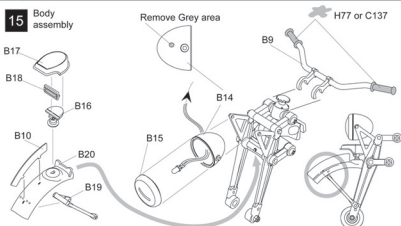

16

## Body assembly

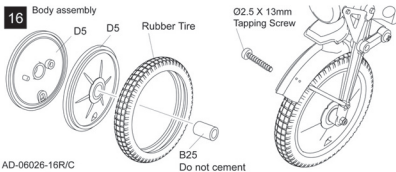

17

## Body Assembly

MA-6

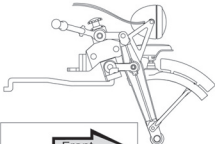

Front

MA-6

18

Body assembly

Steering Servo  
(AD-02013-16E)  
Not IncludedServo arm  
(Remove  
Grey area)

Ø3X6mm

Antenna

2  
Second  
step

6mm

8mm

Ø2X5mm(X2)

1 First step

Ø2X5mm(X2)

AD-06026-16R/C

19

## Tracks assembly

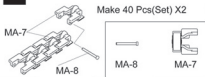

20

## Tracks assembly

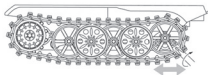
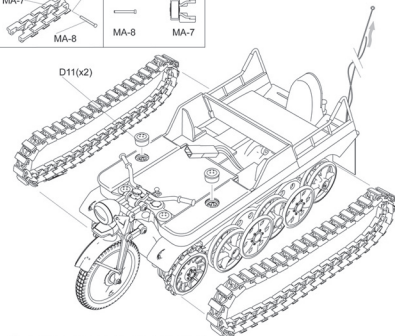

- 1/ Loose the screw as shown
- 2/ Push the rear wheel forward
- 3/ Install the track
- 4/ Push the rear wheel backward and tighten the screw

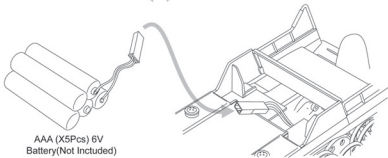

21

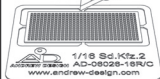
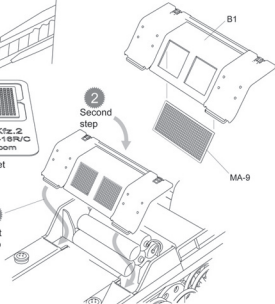
Body  
assemblyPhoto Etched Part Set  
MA-91  
First  
step2  
Second  
step

## DECAL APPLICATION

1a or 2b

3

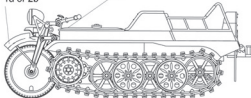

1 or 2



Body Color : German Gray or Dark Yellow



## Color list

Color	GSI Creos (gunze sangyo)	
	Hobby Color	Mr. Color
German gray	H-32	C-40
Dark yellow	H-79	C-39
Tire Black	H-77	C-137

1. Cut off decal from sheet.
2. dip the decal in tepid water for about 10 sec. and place on a clean cloth
3. Hold the backing sheet edge and side decal onto the model.
4. Move decal into position by wetting decal with finger.
5. Press decal gently down with a soft cloth until excess water and air bubbles are gone.

## PARTS

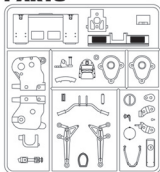

Part "B"

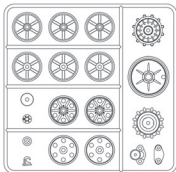

Part "D"(X2)

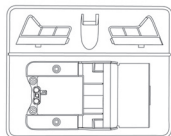

Part "A"

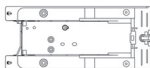

Chassis



Part "C"



Fender



Rubber Tire



Part "E"

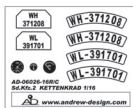

Deco

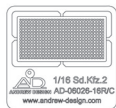

MA-9 Photo Etched



370 Motor



LED(White)

LED(X2 Red)

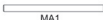

MA1



MA-7

2.6 X13mm  
Tapping screw3X6mm(X2)  
Screw

MA-6



MA2(X2)



MA-8

MA-5 Antenna rod

3X4mm(X2)  
Screw2.6 X 6mm(X16)  
Tapping screw2 X 5mm(X19)  
Tapping screw3mm Nut  
(X2)MA-4(X6)  
For "A" WheelsMA-3(X4)  
For "B" Wheels

AD-06026-16R/C

GEAR BOX

CHASSIS

R/C SYSTEM

BODY

TRACKS

DECOR

## SAFETY PRECAUTIONS

### When Assembly your RC Tank:

Read carefully and fully understand the instructions before commencing assembly. A supervising adult should also read the instructions if a child assemble the model.

When assembling this kit, tools including knives are used. Extra care should be taken to avoid personal injury.

Keep out of reach of small children. Children must not be allowed to suck any part, or pull vinyl bag over the head.

### When using your RC Tank:

Don't run it in the street, on the water pit, sands and carpet...

Don't run it in a place where many people or small children.

Don't run RC Tank in small or enclosed spaces.

Never run your Tank without a top and strikes person, it could cause serious injury.

Never touch any rotating parts such as wheels, shafts or gears with your finger, hair, clothes and etc... It may cause a serious injury.

Due to the friction of moving parts, the motor can become extremely hot.

### When connecting your battery and RC control:

Start to play:

Switch on transmitter ► Connect battery ► Switch on Receiver

Finished to play:

Switch off Receiver ► Disconnect battery ► Switch off Transmitter



[www.andrew-design.com](http://www.andrew-design.com)

[info@andrew-design.com](mailto:info@andrew-design.com)